

HEAVY DUTY 3-WAY STAPLE GUN

User Manual



35112

General Information

Thank you for purchasing a Blue Spot Tools product, you can find further information on our range at **www.BlueSpot.uk.com**. Please ensure that you are using the product correctly and that all guidance and cautions are followed in accordance with the instructions. Please retain these instructions for future reference.

Safe use

Please make sure that you read these instructions carefully to avoid injury when using the staple gun. Follow all health and safety rules and regulations. If in doubt and available please contact a more knowledgeable source.

DO NOT use if damaged.

- If the staple gun is damaged do not use as this may cause damage to property or injury.
- Maintain the staple gun in good and clean condition for best and safest performance.
- Keep the work area clean and uncluttered and ensure that there is adequate lighting.
- Maintain correct balance and footing. Ensure the floor is not slippery and wear non-slip shoes.
- **ALWAYS** dress appropriately.
- **ALWAYS** wear the correct eye or face protection when operating the staple gun.
- Keep children and unauthorised persons away from the work area.
- When not in use store the staple gun in a safe, dry area, away from children.
- **DO NOT** operate the staple gun if any parts are damaged or missing. This may result in product failure or could cause damage to property or injury.
- **DO NOT** get the staple gun wet. Always use in dry locations.
- **DO NOT** force the staple gun to achieve a task that it was not designed to perform.
- **NEVER** point the staple gun at other persons or animals.
- **NEVER** operate the staple gun if you are tired, under the influence of alcohol, drugs or intoxicating medication.

Introduction

The Blue Spot Tools Heavy Duty 3-Way Staple Gun is designed for firing standard staples, round staples and brad nails. Spring-loaded slide strip magazine for quick staple reloading. The palm squeeze trigger provides a simple and easy operation. The staple gun also features a manual depth adjustment control knob.

Introduction (continued)

Suitable for use with:

- 4-14mm staples
- 10-12mm U-Shape staples
- 10-14mm brad nails.

The staple gun includes 200 x 8mm staples, 200 x 12mm U-shape staples and 200 x 10mm nails.



Parts Diagram

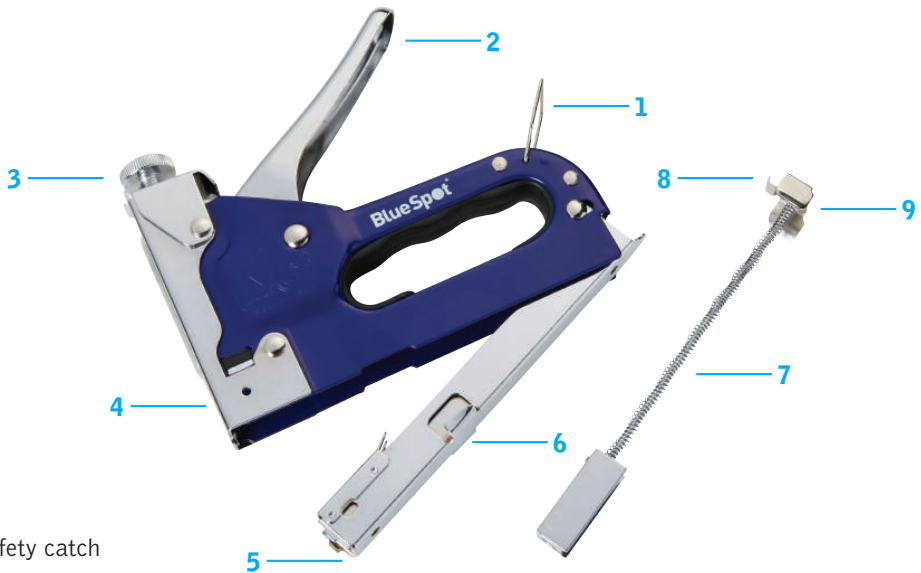

1. Safety catch
2. Trigger
3. Manual depth adjustment control knob
4. Hole for viewing the staples in the staple gun
5. Carriage
6. Grips
7. Pressure rod
8. End plate
9. Plate

Loading the staple gun

1. Hold the stapler in one hand and point away from your body.
2. Push in the plate (9) against the spring pressure disconnecting the end plate (8). Push down slightly to remove the pressure rod and spring assembly (7) from the feed bar. This will withdraw it from the stapler.
3. Insert the new staples or nails into the guidance track. The image below shows the correct way of inserting the different types of staples or nails into the stapler.



4. Reinsert the stapler feed bar and hook it upwards to retain it back into end plate (8) within the stapler.
5. The stapler is now loaded correctly and can be used.

fig.1

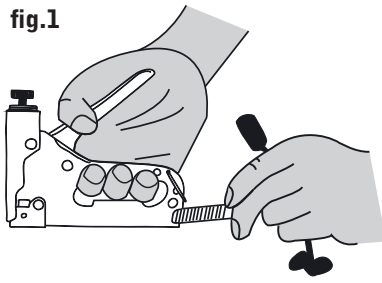

fig.2

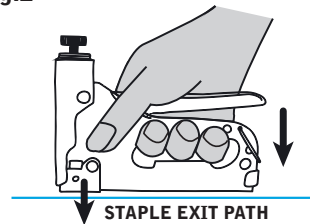

fig.3

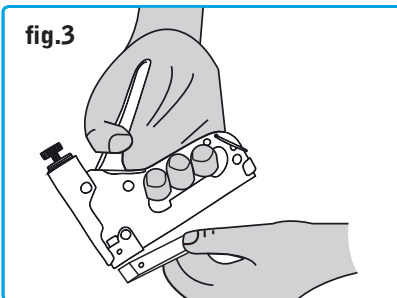
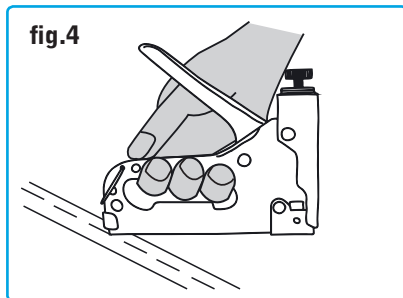

fig.4



How to Use the Stapler

1. Ensure that the stapler is in firm contact with the surface to be stapled and that the stapler is correctly positioned.
2. Depress the trigger (2) firmly until the stapler gun fires (see fig 2).

Adjusting the Stapling Force

1. The stapling force can be adjusted using the manual depth adjustment control knob (3).
2. Turn the knob clockwise to increase the stapling force.
3. Turn the knob anti-clockwise to decrease the stapling force.

How to Remove Staples

1. At the rear end of the soleplate is a semi-circular protrusion that can be used to lever out driven staples (see fig 4).

How to Clear Blockages

1. Hold the stapler in one hand and point away from your body.
2. Push in the plate (9) against the spring pressure disconnecting the end plate (8). Push down slightly to remove the pressure rod and spring assembly (7) from the feed bar.
3. There are two lugs on the front of the stapler which hold the carriage (5) in place with two slots.
4. Securely hold the stapler and pull the carriage back against the spring pressure using the grips (6) on the sides.
5. This will disconnect the two lugs from the two slots.
6. On the carriage (5) apply a downward pressure to release it from the staple gun. Refer to the parts diagram image above to show how this should hang on the hinge of the stapler.
7. Remove any loose staples/nails from the guidance track. Be careful doing this and use pliers if necessary.
8. Reinsert the carriage and ensure the lugs are secured back into the two slots.
9. Reinsert the stapler feed bar and hook it upwards to retain it back into end plate (8) within the stapler.

Storing the stapler

When you have finished using the stapler and are storing it away for future use always ensure the following has been done –

- Any remaining staples or nails left in the stapler have been removed. Follow the steps above on how to do this correctly.
- Unscrew the adjustment control knob (3) before storing away to release any pressure within the staple gun.
- The trigger (2) should also be secured with the safety catch (1).

Environmental Protection

Recycle unwanted materials instead of disposing of them as waste. All tools, accessories and packaging should be sorted, taken to a recycling centre and disposed of in a manner which is compatible with the environment. When the product becomes completely unserviceable and requires disposal, drain any fluids (if applicable) into approved containers and dispose of the product and fluids according to local regulations.



Contact

Find out more about the Blue Spot Tools Lifetime Guarantee at **www.BlueSpot.uk.com**

Tel: 0800 093 0115

Email: sales@bluespot.uk.com

Orme Business Centre,
Greenacres Road,
Oldham,
OL4 3NS