

LONG ARM RIVET (3.2-6.4) AND RIVETER (M4-M10) SET

User Manual



General Information

Thank you for purchasing a BlueSpot product, you can find further information on our range at **www.BlueSpot.uk.com**. Please ensure that you are using the product correctly and that all guidance and cautions are followed in accordance with the instructions. Please retain these instructions for future reference.

Safe use

Please make sure that you read these instructions carefully in order to avoid injury when using the riveter. Follow all health and safety rules and regulations. If in doubt and available please contact a more knowledgeable source.

DO NOT use if damaged.

- Maintain tool in good and clean condition for best and safest performance.
- Keep the work area clean, uncluttered and ensure there is adequate lighting.
- Maintain correct balance and footing. Ensure the floor is not slippery and wear non-slip shoes.
- Keep children and unauthorised persons away from the work area.
- If the riveter is damaged do not use.
- **NEVER** leave the riveter unattended. When you have finished using the riveter it should be stored away in a safe place that is out of reach of children.
- **NEVER** try to get the riveter to perform a task that it was not made for. Do not overload or misuse the tool.
- **ALWAYS** dress appropriately – clothing should be close fitted and long hair tied back. Jewellery should be removed and shoes should be worn with a non-slip sole.
- **ALWAYS** wear the correct eye or face protection when operating the riveter.
- **ALWAYS** wear approved respiratory protection. This will help protect you from any dust.
- **ALWAYS** ensure you work in a well ventilated room.
- **ALWAYS** ensure that adjusting keys and wrenches have been removed before using the tool. If a key or wrench is still attached when the tool is used this could cause damage to property or cause injury.
- **NEVER** operate the tool if you are under the influence of drugs or alcohol as this is dangerous.
- **DO NOT** operate the riveter if you are tired as this is dangerous.
- **DO NOT** get the riveter wet. Always use in dry locations/conditions.
- **ALWAYS** check and adhere to national regulations when disposing of the riveter.

Introduction

The Blue Spot Tools Long Arm Rivet (3.2-6.4) and Riveter (M4-M10) Set is ideal for professional and DIY use. Suitable for use with steel, stainless steel and aluminium rivets/rivet nuts. Heavy-duty ergonomic handles. Includes wrench to change the mandrels, 5 rivet nose pieces and 5 interchangeable mandrels.

Contains: M4 x 0.7, M5 x 0.8, M6 x 1, M8 x 1.25, M10 x 1.5mm mandrels, 3.2, 4.0, 4.8, 6.0, 6.4mm rivet nose pieces and 3 x wrenches.

Parts Diagram

Included within the box

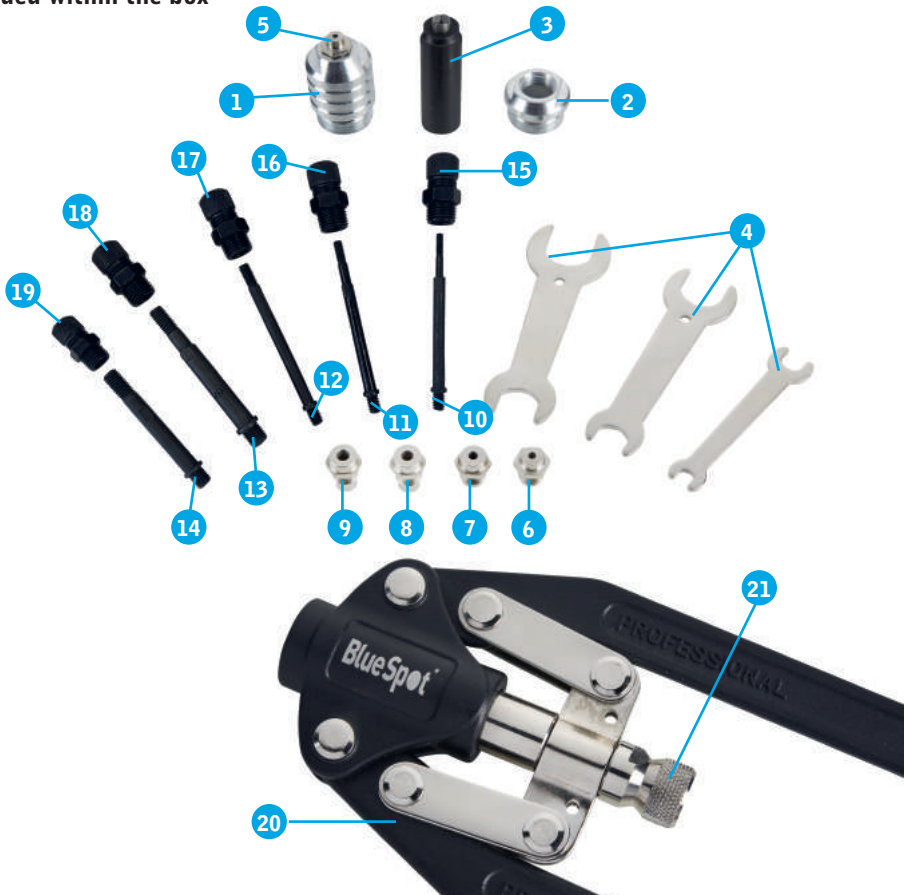

Parts Diagram (continued)

1	Front sleeve for rivets
2	Front sleeve for nut rivets
3	Riveting jaw case
4	Spanners
5	3.2mm Riveting nose piece
6	4.0mm Riveting nose piece
7	4.8mm Riveting nose piece
8	6.0mm Riveting nose piece
9	6.4mm Riveting nose piece
10	M4 x 0.7mm Nut rivet mandrel
11	M5 x 0.8mm Nut rivet mandrel
12	M6 x 1.0mm Nut rivet mandrel
13	M8 x 1.25mm Nut rivet mandrel
14	M10 x 1.5mm Nut rivet mandrel
15	M4 Fixing Screw
16	M5 Fixing Screw
17	M6 Fixing Screw
18	M8 Fixing Screw
19	M10 Fixing Screw
20	Nut Riveter
21	Pull bar

Changing the nut rivet mandrel on the riveter

NOTE – The nut rivet mandrels have a different size thread. However, inside the riveter there is a double thread so each of the nut rivet mandrels will securely attach.

1. Choose the nut rivet mandrel (10-14) for the chosen rivet from the kit.
2. Unscrew the front sleeve for rivets (1) from the riveter (20) with the suitable spanner (4) from the set and put to one side. The riveter (20) has a left handed thread so the sleeve will need to be unscrewed anticlockwise.
3. Unscrew the riveting jaw case (3) using one of the suitable spanners from the set and remove from the riveter (20). Put this to one side.
4. Securely attach and screw the nut rivet mandrel (10-14) into the riveter. Screw this into the riveter (20) anticlockwise to ensure it is secure.
5. Attach the front sleeve for nut rivets (2) back over the riveter (20). Use a suitable spanner (4) from the set to screw this back onto the riveter (20) clockwise and tighten.
6. Attach the suitable fixing screw (15-19) that matches up with the riveter mandrel (10-14) you have attached into the riveter (20) and secure this using one of the suitable spanners (4) from the set. You may need to adjust the fixing screw (15-19) to get the correct working stroke.
7. The nut rivet mandrel (10-14) and fixing screw (15-19) should now be securely attached into the riveter (20) and be ready to use.



Changing the nose piece on the riveter for nuts

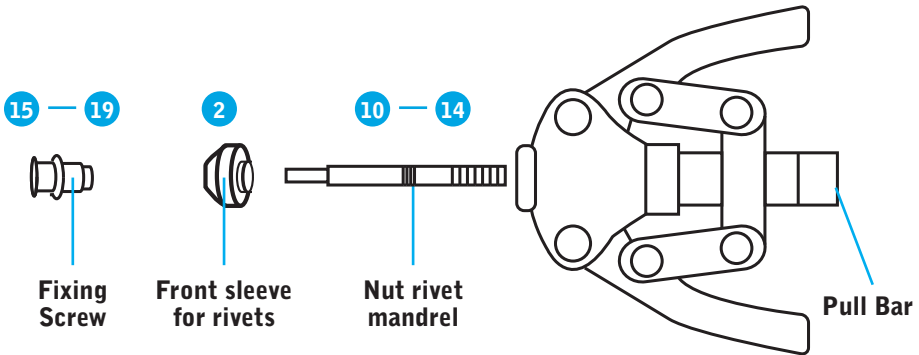

Operation

Note – We always recommend testing this first on a test piece of material until you become comfortable operating the nut riveter.

1. On the workpiece drill the recommended diameter hole for the nut rivet.
2. Follow the steps above for correctly assembling the riveter (20) with the nut rivet within the nut rivet mandrel (10-14).
3. Open the handles of the riveter (20) so they are as wide as they can be.
4. Secure the nut rivet into the nut rivet mandrel (10-14) on the riveter (20) and set into the hole of the workpiece that you drilled.
5. Tighten the handle of the riveter (20) using the screw depth adjustment on the pull bar (21).

Note –If the nut is not tight enough with the workpiece, release the handles of the riveter to fasten the pull bar (21) and then tighten the handles of the riveter again.

6. To separate the nut rivet and nut rivet mandrel (10-14), release the riveter handles (20) and pull bar (21).
7. The nut will now be securely inserted into the workpiece.

Changing the nose piece on the riveter for rivets

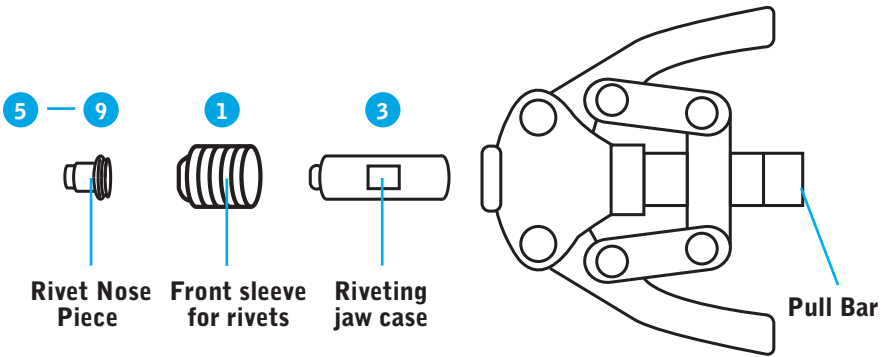

1. Choose the riveting nose piece (5-9) for the chosen rivet from the riveter kit.
2. Securely attach the riveting nose piece (5-9) into the front sleeve for rivets (1) on the riveter (20). This will need to be screwed in using a suitable spanner from the set. The riveter (20) has a left handed thread so the sleeve will need to be screwed in clockwise.
3. The riveting nose piece (5-9) should now be securely attached into the riveter (20).

Operation

Note – We always recommend testing this first on a test piece of material until you become comfortable operating the nut riveter.

1. On the workpiece drill the recommended diameter hole for the riveting nose piece (5-9).
2. Follow the steps above for correctly assembling the riveter (20) with the riveting nose piece (5-9).
3. Open the handles of the riveter (20) so they are as wide as they can be.
4. Secure the rivet into the riveting nose piece (5-9) on the riveter (20) and set into the hole of the workpiece that you drilled.
5. Close the handles of the riveter (20). You may need to open and close the handles 1 or 2 times for the rivet to be cut.
6. Release the handles fully and remove the tool from the workpiece.



Cleaning & Maintenance

To clean just use a dry cloth to wipe over the riveter

Storage

ALWAYS ensure the riveter and riveter nuts is stored out of reach of children.
Store the tool in a secure, dry place.

Disposal

Always check and adhere to national regulations when disposing of any tools that are no longer functional and cannot be repaired.

- Contact your local waste disposal authority for information on how to correctly dispose of tools.

Environmental Protection

Recycle unwanted materials instead of disposing of them as waste. All tools, accessories and packaging should be sorted, taken to a recycling centre and disposed of in a manner which is compatible with the environment. When the product becomes completely unserviceable and requires disposal, drain any fluids (if applicable) into approved containers and dispose of the product and fluids according to local regulations.



Contact

Find out more about the Blue Spot Tools® Lifetime Guarantee at **www.BlueSpot.uk.com**

Tel: 0800 093 0115

Email: sales@bluespot.uk.com

Orme Business Centre,
Greenacres Road,
Oldham,
OL4 3NS