

## MOTORCYCLE CHAIN BREAKER

### User Manual



07903

## General Information

**Thank you** for purchasing a Blue Spot Tools product, you can find further information on our range at **[www.bluespot.uk.com](http://www.bluespot.uk.com)**. Please ensure that you are using the product correctly and that all guidance and cautions are followed in accordance with the instructions. Please retain these instructions for future reference.

## Introduction and Specification

This tool is designed to break various types of chain. The tool is suitable for use with drive or cam chains ranging from #35 to #630. Supplied with three breaking tips: 2.2, 2.9 and 3.80.

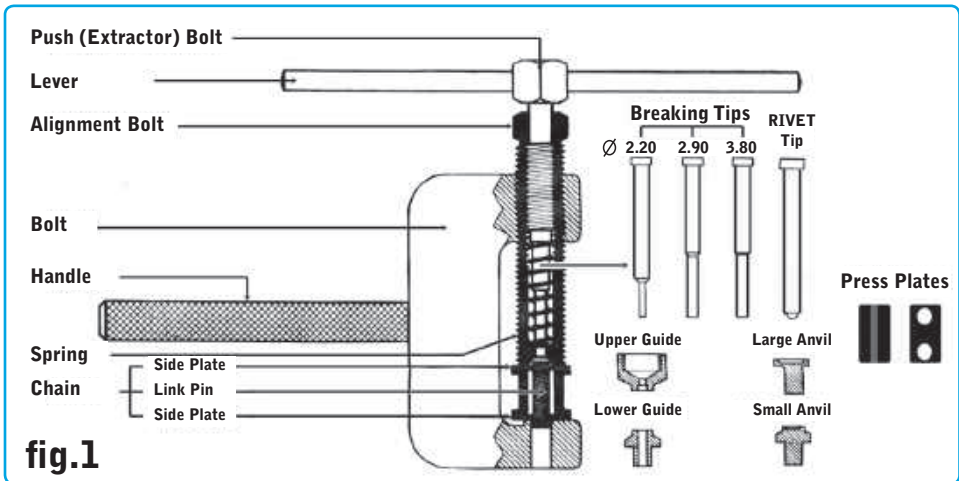

## How to use

It is very important to note when breaking chains #520 and higher that the breaking tip can potentially snap if the existing chain pin is not ground flush to the face of the chain body. In the event that the chain is not properly prepared for breaking we are unable to provide replacement pins under the Blue Spot Tools lifetime guarantee.

fig.2

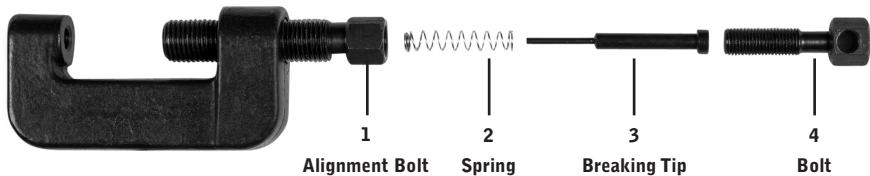

## Extracting chain link pin

1. To break the chain you must first grind the existing rivet down as stated above (for chains #520 and higher). This is the most important step of the whole process in order to achieve a successful outcome.
2. Prepare the tool as instructed in fig 2.
3. Select the breaking tip to be used with the chain (fig 2.3) and proceed to remove the push bolt from the breaker body. Place the spring (fig 2.2) over the breaking tip and then into the alignment bolt (fig 2.1) followed by the push bolt (fig 2.4) as shown above in fig 2.

### NOTE

When using the smallest tip in the set (2.2mm) you must utilise the upper and lower guides so that you don't damage the breaking tip. The 2.2mm tip should be used with cam chains, 2.9mm pin #25 or #35 chain and 3.8mm pin for most motorcycle chains.

4. Please make sure that the breaking tip is withdrawn a minimum of 2mm into the alignment bolt.
5. Put the body of the breaker over the chain and begin to wind the push bolt through the chain link pin. The existing chain link pin will drop from the bottom of the tool.

## NOTE

If you find that extreme force is required please repeat step 4 above make sure that the breaking tip is aligned with the chain link pin otherwise you risk damaging the breaking tip. The breaking tip if misaligned could be pushing against the body of the chain and this will result in a failure.

6. Once you have successfully removed the old chain link pin you can disassemble to the tool.

## Installing chain link pin

1. Place the rivet tip and anvil in the tool.
2. Assemble the chain ready for the new link pin to be riveted. At this stage you should not re use the old link pin as it will be weakened also do not use clip type connecting links.
3. Take care that the side plates with pins attached lines up with the grooved press plate.
4. Begin to tighten the push bolt. Carry this out until you can see that the link pins are protruding.
5. Once you have completed the above remove the tool from the chain and check that the procedure has been successful.

## Contact

Find out more about the Blue Spot Tools<sup>®</sup> Lifetime Guarantee at [www.bluespot.uk.com](http://www.bluespot.uk.com)

Tel: 0800 093 0115

Email: [sales@bluespot.uk.com](mailto:sales@bluespot.uk.com)

Unit 64, Boswell Way,

Stakehill Industrial Estate,

Middleton,

M24 2RW